

HS-820 VACUUM SERIES



Materials



Sprockets



Applications

Plate Materials : POM-DP,POM-LF

Pin Material : Cold rolled austenitic stainless steel

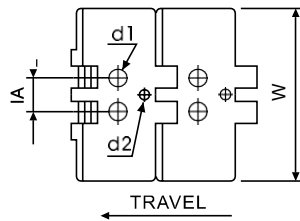
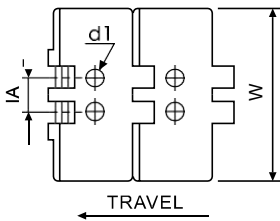
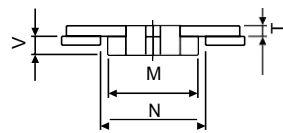
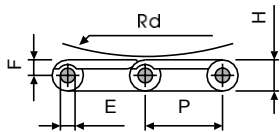
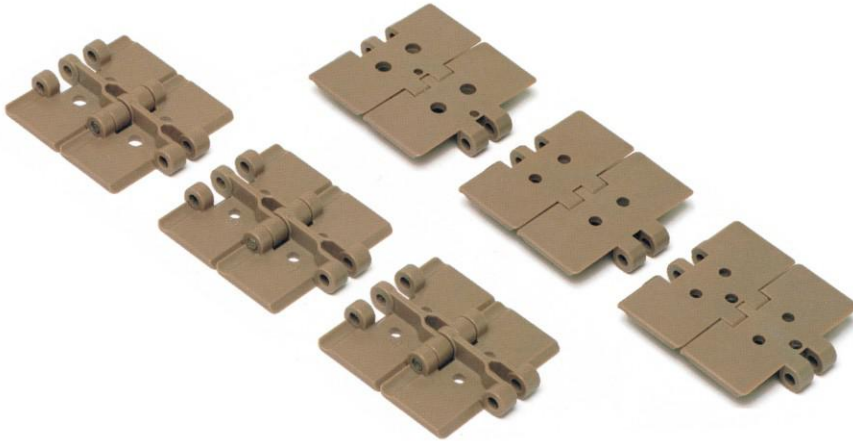

Dimension	mm	inches
P	38.1	1.500
W	-	-
H	13.5	0.531
T	4.0	0.157
E	6.4	0.252
M	42.1	1.657
F	7.2	0.283
V	9.5	0.374
N	44.5	1.752
RD	40.0	1.575

HS-820 VACUUM (Straight Running Plastic Chain)

CHARACTERISTICS

	Width W		Working Load		d1		d2	IA		Weight (kg/m)
	(mm)	(inch)	N(21°C)	lbs(21°C)	(mm)	(inch)	(mm)	(mm)	(inch)	
HS-820-K325 B2	82.5	3.25	1230	276	6.5	0.26	-	19	0.75	0.83
HS-820-K350 B2	88.9	3.50	1230	276	4.0	0.16	-	45	1.77	0.87
HS-820-K450 B2 H30	114.3	4.50	1230	276	8.0	0.31	-	30	1.18	1.03
HS-820-K450 B2 H50	114.3	4.50	1230	276	8.0	0.31	-	50	1.97	1.03

*IA=Distance between centres.

*B1=one bore B2=two bores