

HS-820-EL SERIES



Materials



Sprockets



Applications

Plate Materials: POM-DP,POM-LF

Pin Material: Cold rolled austenitic stainless steel

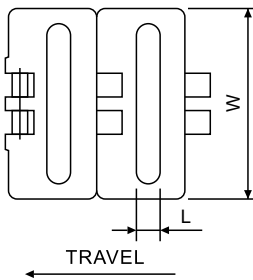
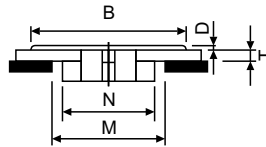
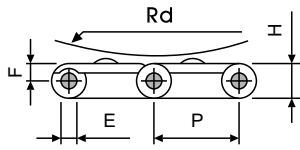
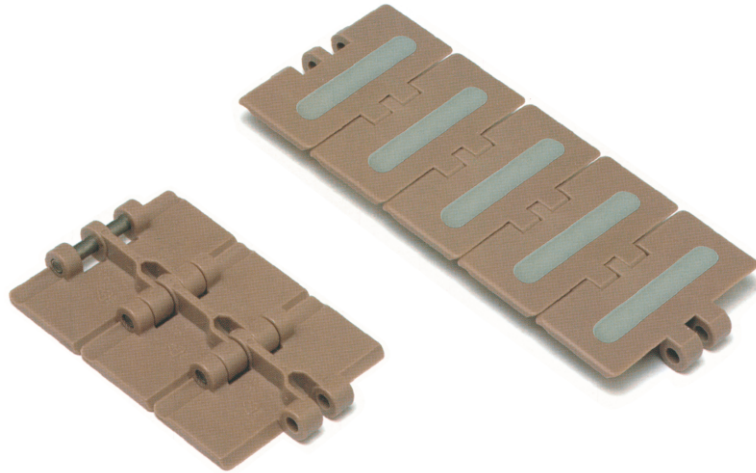

Dimension	mm	inches
P	38.1	1.500
W	-	-
E	6.4	0.250
T	4.0	0.157
F	7.2	0.283
M	44.5	1.752
N	42.1	1.657
D	2.0	0.079
L	10.0	0.394
H	13.5	0.531
RD	178.0	7.008

B:65. 0/101. 6/114. 3/135. 0

HS-820-EL (Straight Running Plastic Chain)

CHARACTERISTICS

	Width W		Working Load		Radius		Reverse Radius		Weight (kg/m)
	(mm)	(inch)	N(21°C)	lbs(21°C)	(mm)	(inch)	(mm)	(inch)	
HS-820-EL-K325	82.5	3.25	1230	276	-	-	40	1.575	0.83
HS-820-EL-K400	101.6	4.00	1230	276	-	-	40	1.575	0.95
HS-820-EL-K450	114.3	4.50	1230	276	-	-	40	1.575	1.03
HS-820-EL-K600	152.4	6.00	1230	276	-	-	40	1.575	1.25